



GVN11 PRO

Home Lift

GiantKONE Elevator Co., Ltd.

2005 Xunzhi Rd. Nanxun Economic Development Zone,
Huzhou, Zhejiang, P.R.China
P.C. 313009
Tel.: +86-572-3017777
Mobile: +86 181 0582 5368
Mail: gke@giantkone.com

8A88 Shanghai Mart, 2299 Yan An Rd(W)
Shanghai P.R.China
P.C. 200336
Tel.: +86-572-3017777
Mobile: +86 181 0582 5368
Mail: gke@giantkone.com





GKE is a strategic brand of GiantKONE Elevator Co. Ltd. in overseas market. GiantKONE, founded in 2005, is a leading Elevator & Escalator solution provider in China market.

As a key member of a highly acclaimed international enterprise, our mission is to make urban life better with products and services of excellent affordability, outstanding technology, and remarkable reliability over the full life cycle.

GKE home lift is a machine-roomless home elevator developed to meet the needs of middle and high-end villas/townhouses/duplex apartments.

Adhering to the concept of safety, technology and humanity, GKE brings convenience and comfort to every family, the convenience we can provide to you will highlight your honor and enhance the value.

Specifications

| Speed (m/s) | Load Capacity (kg) | Maximum Travel (m) | Maximum Number of Landings |
|--------------|--------------------|--------------------|----------------------------|
| 0.4/0.63/1.0 | 250/320/400 | 18 | 6 |

FEATURES & ADVANTAGES

- SAFETY AND RELIABILITY**

GKE home lifts are designed with safety as a core principle. They are equipped with a power failure automatic rescue device and a one-key call alarm function, which provide users with the highest level of protection.
- GREEN AND ENVIRONMENT-FRIENDLY**

The single-phase 220V power supply reduces the application barrier.

The daily energy consumption of a home elevator is less than that of a refrigerator.
- COMFORTABLE RIDE**

GKE home lift features a permanent magnet synchronous gearless traction machine, which effectively reduces noise pollution. Its advanced vector conversion technology allows for real-time speed adjustments based on human comfort requirements, ensuring a safe and comfortable ride.
- DEXTEROUS LAYOUT**

Machine room-less design, low overhead solution requires only 2750mm overhead and 400mm pit depth, while the low pit solution requires only 2850mm overhead and 200mm pit depth. These specifications effectively improve the utilization rate of the building and provide more creative space for designers.

Power Failure Automatic Rescue Device



- In the event of an emergency power failure, the emergency lighting in the car is switched on and the lift switches to the back-up power source.



- The lift will automatically travel to the nearest floor, open the door and release passengers for automatic rescue.





- The lift will return to normal when power is back on.



One-touch Call Alarm

Push the button to call your mobile phone / property directly

 Family

 Property

 Friend

*Safety Escort
Peace of Mind
on Every Journey*

*Frequency Bands
LTE-FDD B1/B3/B5/B7/B8/B20
GSM/GPRS/EDGE 900/1800 MHz

ALUMINUM
ALLOY FOR
SCENIC
ELEVATOR
STYLISH
DESIGN AND
EASY TO
INSTALL

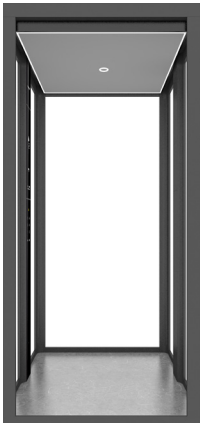

QR CODE

Different colors for option

Champagne

Phantom Black

Pearl White





CAR RECOMMENDATION

◀ Mixed Car

Ceiling : G1025052(304 Stainless steel cladding • Linear light)
Car wall : 304 Hairline stainless steel
Floor : 51950073 (PVC)
COP : 016



GKE



Nordic Style ▶

G1025054 : Ceiling
(304 Stainless steel cladding • Downlight)
Hairline stainless steel • Wood grain steel plate : Car wall
51950074(PVC) : Floor
016 : COP

Optinal color



GKE



CAR RECOMMENDATION

◀ Wooden Style

Ceiling : Aluminum frame • Acrylic
Front wall : Black satin DPM steel plate
Car door : Black satin DPM steel plate
Sidewall : Wood grain DPM steel plate •
Black satin grain DPM steel plate
Rear wall : Wood grain DPM steel plate •
Wood grille • Light strip

Floor : 52031399(PVC)
COP : 016

*The net depth of the car is the distance from the front car wall to the bottom of the wooden grille on the rear car wall



GKE

Glided Moment ▶

Champagne ripple stainless steel : Ceiling
+ Light strip
Champagne steel plate : Front wall
Champagne steel plate : Car door
Champagne mirror stainless steel : Sidewall
+ Champagne steel plate

Champagne steel plate, Stone : Rear wall
patterned steel plate + Light strip

52031399(PVC) : Floor
016 Champagne swing operator : COP

*The net depth of the car is the distance from the front car wall to the rear car wall stone pattern steel plate



GKE



SIGNALIZATION
FOR SCENIC CAR

SWING COP /



ELEGANT SIGNALIZATION (016)

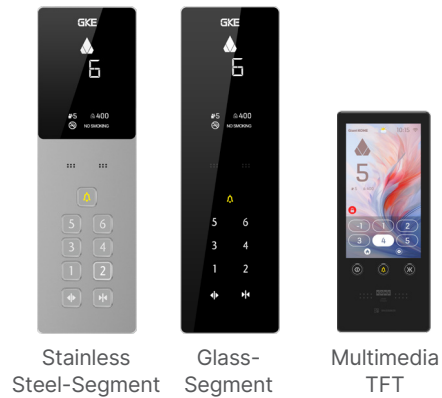

Stainless
Steel-Segment

Glass-
Segment

Multimedia
TFT

/ LOP /

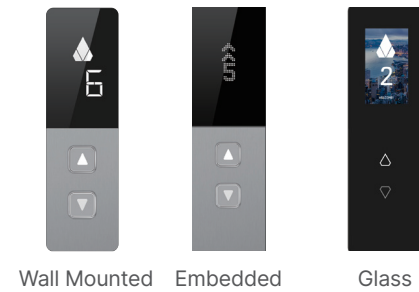

Wall Mounted

Embedded

Glass

/ COP & LOP display /

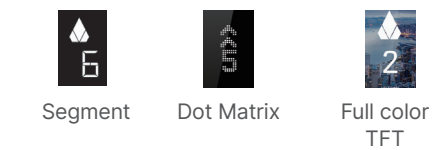

Segment

Dot Matrix

Full color
TFT

/ CEILING /

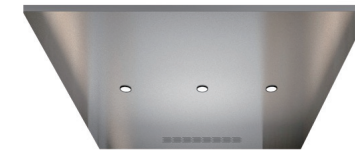

G1025054
stainless steel 304, LED light



G1025052
Stainless steel 304, LED light



G1025053
Aluminum Frame Acrylic panel

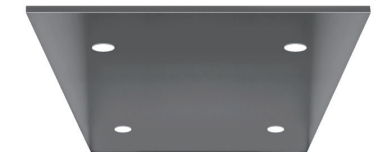

G1025057
Mirror stainless steel, LED light

/ FLOOR /

PVC ►



51950073



51950074



G4083001

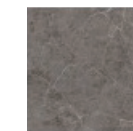

51782380

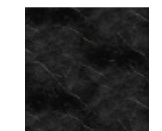

51782381

Marble ►

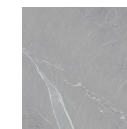

51781628



G4003015

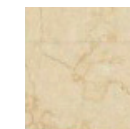

G4003014

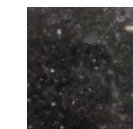

G4003013

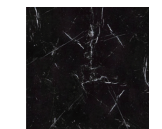

51781629

CEILING & FLOOR

ELEVATOR FUNCTION TABLE

| | | |
|---|--|--------------------------|
| | | ● Standard ○ Optional |
| SECURITY FUNCTIONS | | |
| Rescue and fault monitoring | | |
| COD | Fix the run | ● |
| DTS | Runtime detection | ● |
| BMV R | Resistor braking | ● |
| RDF RC | Emergency electric operation | ● |
| LBI | Brake release device | ● |
| Emergency backup power and power restoration operations | | |
| LPS TN | Synchronous run | ● |
| CEL S | Emergency car lighting | ● |
| EBS S | Emergency battery powered | ● |
| PEL | Power outage emergency leveling | ● |
| Emergency communications | | |
| IF | Intercom function | ● |
| Other safety functions and maintenance | | |
| SWD | Maintenance operation | ● |
| BOF | Door open and close button for maintenance | ● |
| CDC | Car door contact | ● |
| CDL O | Car door limit switch | ● |
| DOP | No door allowed | ● |
| EMH | Pit emergency stop switch | ● |
| EMR | Car roof emergency stop switch | ● |
| LCD | Disable LOP function | ● |
| OSG CM | Car speed limiter safety switch | ● |
| SGE | safety gear safety switch | ● |
| TWC | Speed limiter tightening safety switch | ● |
| ASC | Elevator upward overspeed protection | ● |
| DCD | Door lock circuit detection | ● |
| ISM | Overhauling safety mechanical blocking devices | ● |
| IST | Repair safety pin | ● |
| CLF C | Car lighting main switch - Control cabinet | ● |
| MAS C | Elevator main switch- Control cabinet | ● |

PASSENGER COMFORT FUNCTIONS

| | | |
|------------------------------|--|---|
| Entering and exiting the car | | |
| DCB | Door close button | ● |
| DOB | Door open button | ● |
| QCC | Cop opens the door quickly | ● |
| REO O | LOP reopens | ● |
| IWF | Intelligent waiting function | ○ |
| SRC RNC | Single light curtain | ● |
| Abuse, misuse protection | | |
| SPB BP | Button adhesion monitoring | ● |
| FCC R | Press twice to cancel the COP button command | ● |
| CCB | Reverse COP call | ● |
| Running comfort | | |
| VVVF E | Elevator variable frequency drive | ● |
| OCL A | Car lighting automatic control | ● |
| OCV A | Car ventilation automatic control | ● |

CONTROL FUNCTIONS

| | | |
|---------------------|--------------------------------------|---|
| Idle car allocation | | |
| PAM | Automatically return to base station | ● |
| IAF | Intelligent anti-aging function | ○ |

INFORMATION FUNCTIONS

| | | |
|--|---|---|
| Information display outside the hall | | |
| LCL | LOP registration indicator light | ● |
| Information display in the car | | |
| OLF C | Car overload function | ● |
| CCL | COP registration indicator light | ● |
| ACU F | Voice station announcement | ○ |
| Information display in the control cabinet | | |
| CPI PS | Car position display | ● |
| SCN N | Start counter | ● |
| CIL A | Labels on components inside the control cabinet | ● |
| DZI N | Door area instructions | ● |

SPECIFICATIONS

| Car height (mm) | Door height (mm) | Overhead (mm) | Pit depth (mm) |
|-----------------|------------------|---------------|----------------|
| 2100 | 2000 | 2750 | 400 |
| 2200 | 2100 | 2850 | |
| 2300 | 2200 | 2950 | |

Minimum pit depth can be 300mm, please consult GKE Sales team. Different ceiling may influence overhead.

| Load Capacity (kg) | Door type | Car dimensions (mm) | Door net width (mm) | Doorway width (mm) | Minimum shaft dimensions (mm) | Shaft type |
|--------------------|-----------------|---------------------|---------------------|--------------------|-------------------------------|------------|
| 4/320 | Side opening | 900×1100 | 700 | 900 | 1400×1450 | Concrete |
| 4/320 | central opening | 900×1100 | 700 | 900 | 1550×1400 | |
| 5/400 | Side opening | 1100×1100 | 800 | 1000 | 1600×1450 | |
| 5/400 | central opening | 1100×1100 | 800 | 1000 | 1750×1400 | |

| Car height (mm) | Door height (mm) | Overhead (mm) | Pit depth (mm) |
|-----------------|------------------|---------------|----------------|
| 2100 | 2000 | 2850 | 200 |
| 2200 | 2100 | 2950 | |
| 2300 | 2200 | 3050 | |

Minimum pit depth can be 150mm, please consult GKE Sales team. Different ceiling may influence overhead.

| Load Capacity (kg) | Door type | Car dimensions (mm) | Door net width (mm) | Doorway width (mm) | Minimum shaft dimensions (mm) | Shaft type |
|--------------------|-----------------|---------------------|---------------------|--------------------|-------------------------------|------------|
| 4/320 | Side opening | 900×1100 | 800 | 1000 | 1410×1440 | Concrete |
| 4/320 | central opening | 900×1100 | 700 | 900 | 1550×1350 | |
| 5/400 | Side opening | 1100×1100 | 900 | 1100 | 1610×1440 | |
| 5/400 | central opening | 1100×1100 | 800 | 1000 | 1750×1350 | |

| Load Capacity (kg) | Door type | Car dimensions (mm) | Door net width (mm) | Doorway width (mm) | Minimum shaft dimensions (mm) | Reserved shaft dimensions (mm) | Shaft type |
|--------------------|-----------------|---------------------|---------------------|--------------------|-------------------------------|--------------------------------|------------|
| 4/320 | Side opening | 900×1100 | 750 | 750 | 1400×1440 | 1490×1520 | Aluminum |
| 4/320 | central opening | 900×1100 | 700 | 700 | 1550×1350 | 1640×1430 | |
| 5/400 | Side opening | 1100×1100 | 900 | 900 | 1600×1440 | 1690×1520 | |
| 5/400 | central opening | 1100×1100 | 800 | 800 | 1750×1350 | 1840×1430 | |

CONSTRUCTION SKETCH

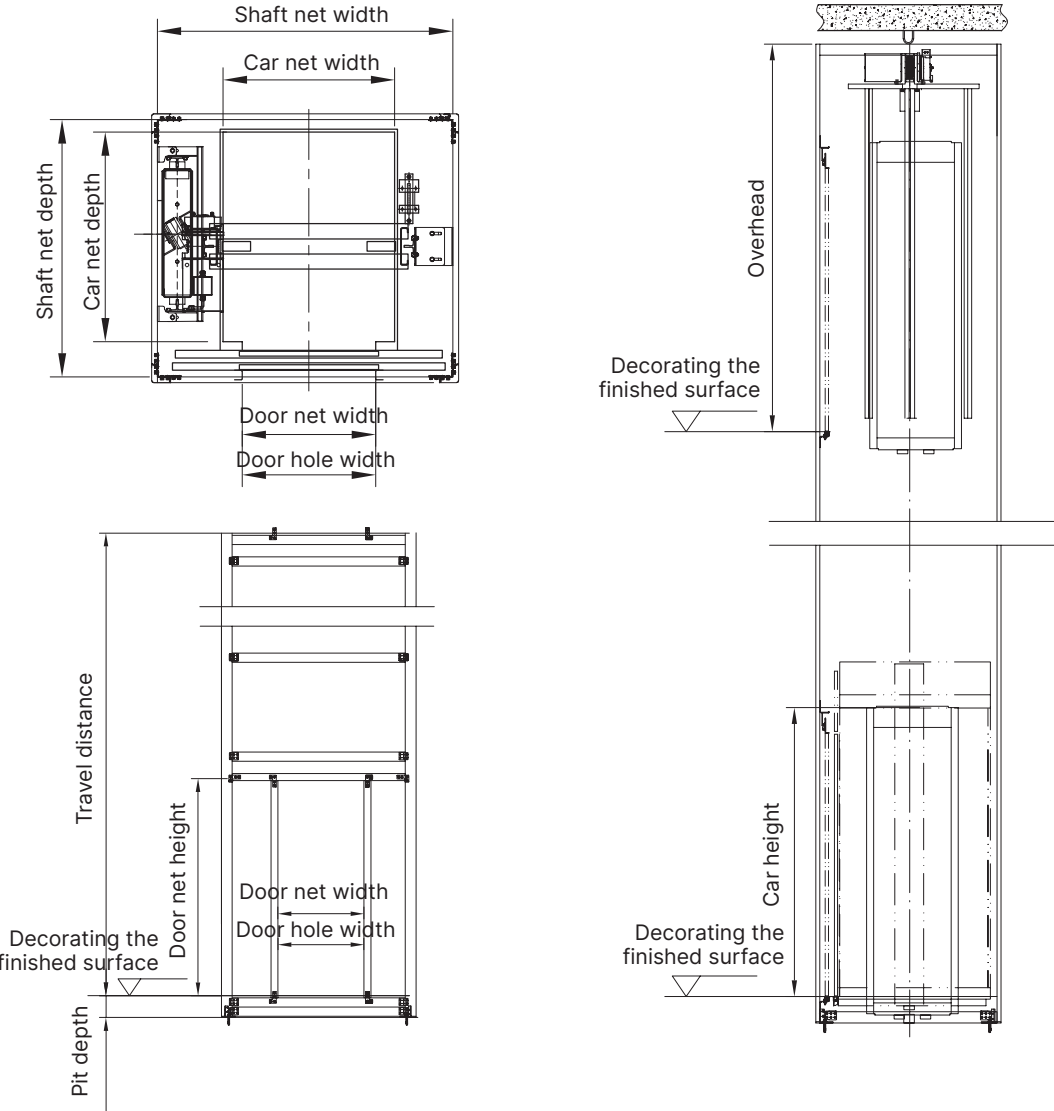

Two panels, Central opening (Scenic shaft)

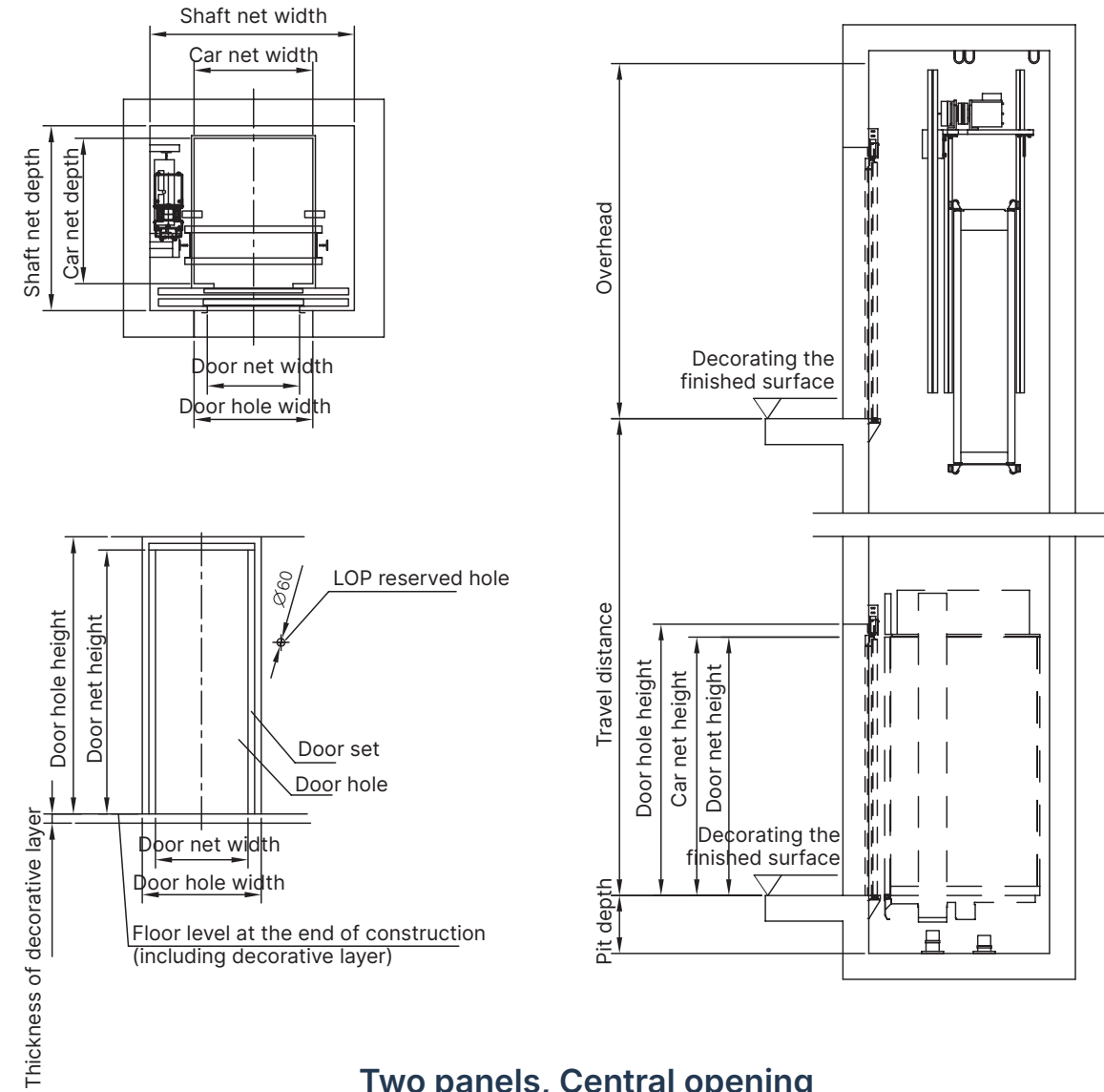

Two panels, Central opening

CONSTRUCTION SKETCH

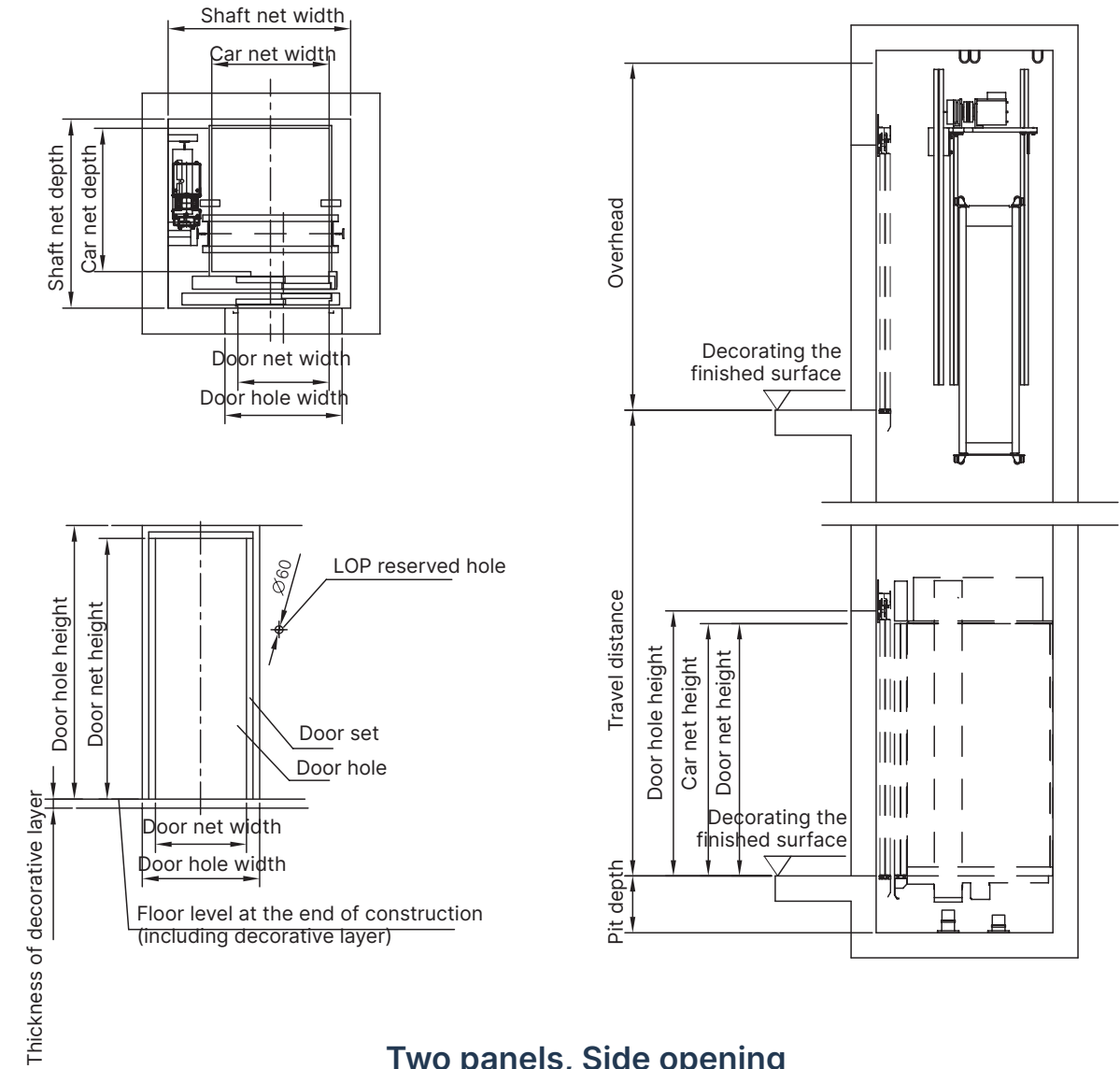

Two panels, Side opening